

STATE OF FLORIDA
COUNTY OF PALM BEACH

KNOW ALL MEN BY THESE PRESENTS:
That NOBLE PADGETT of WEST PALM BEACH, County of
PALM BEACH and State of FLORIDA, the owner in fee of that
certain tract of land shown herein as Section 20, Township
22 S. R. 37 E. 1st, in Palm Beach County, Florida, has
caused the same to be surveyed and platted, and does hereby
dedicate to the perpetual use of the Public, as public high-
ways all the roads, easements and other things reserved unto
himself, his heirs, legal representatives and assigns, the
reversion and reversions thereof whenever said roads shall
be abandoned by the public or discontinued by law.

In Witness Whereof, the said
NOBLE PADGETT has hereunto set his hand and seal this
15th day of September, A. D. 1917.

Noble Padgett
Owner.

Signed and sealed in
the presence of:
W. E. Brown
J. R. Rowley

STATE OF FLORIDA
COUNTY OF PALM BEACH

Before me, an officer authorized to
administer oaths and take acknowledgments, personally
appeared NOBLE PADGETT, to me well known, and known
by me to be the person described in said who executed the
 foregoing instrument for the uses and purposes therein
expressed.

Witness my hand and official seal of West
Palm Beach, County of Palm Beach and State of Florida,
this 15th day of September, A. D. 1917.

J. E. Brown
Notary Public.

My Commission Expires
January 9, 1921

STATE OF FLORIDA
COUNTY OF PALM BEACH

I hereby certify that I have drawn
the plat and map shown as Section 20, Township
22 S. R. 37 E. 1st, Palm Beach County, Florida, from the
survey of same by L. D. Franklin, and that same
is correct representation of said survey to the best of
my knowledge and belief.

H. C. Sigala

Subscribed and sworn to before me this 15th day of Septem-
ber, A. D. 1917.

J. E. Brown
Notary Public.

My Commission Expires
January 9, 1921

SP 29th Sept 1917
17
Chas. J. ...
...

Subdivision of
SECTION 20, T. 22 S. R. 37 E
PALM BEACH COUNTY, FLA.
for
NOBLE PADGETT

SCALE 1 INCH = 300 FT.

L. D. FRANKLIN, ENGINEER

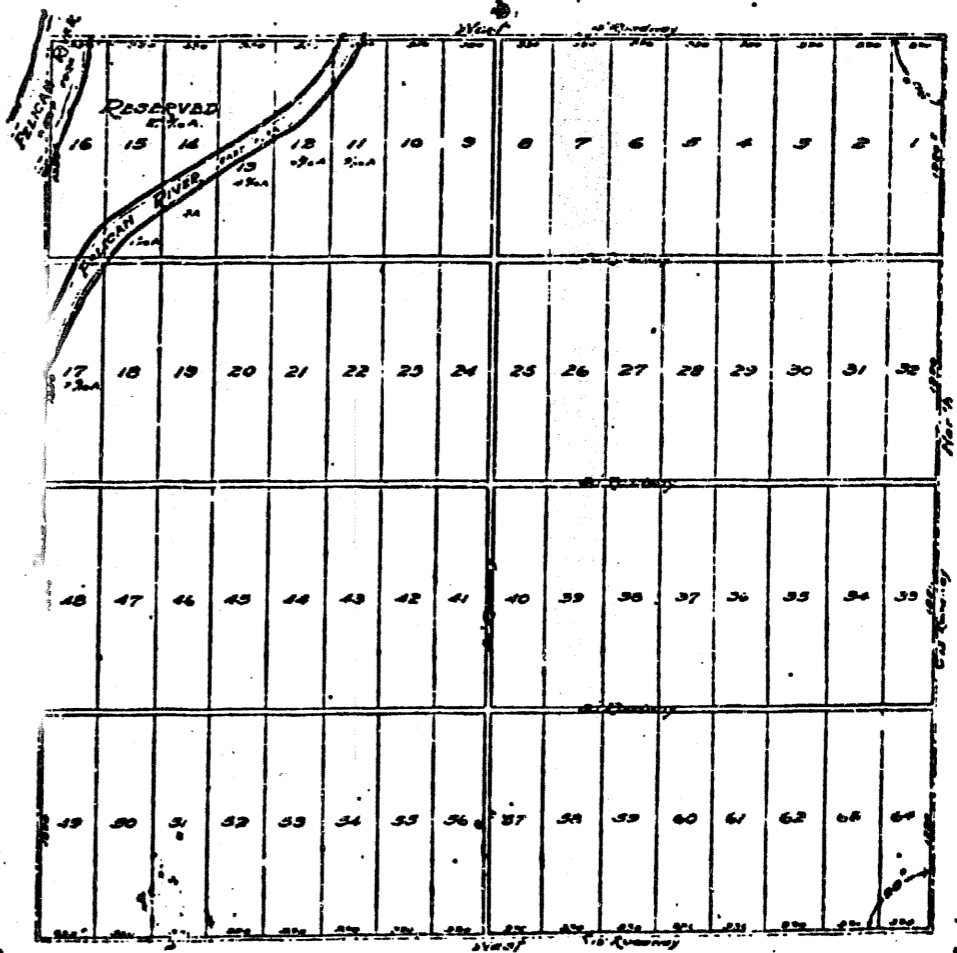

NOTE: Lots Beginning at Road from Section to Center of Road

1000-833